



## KCG 51A CORNER GUARD

### DESCRIPTION

The GUARDIO CORNER GUARD are specially designed to take the impact and reduce the damage caused to the Hospital walls due to the movement of the stretchers, wheelchairs, movable medical/hospital instruments, etc. These wall guards are specially made out of THERMO PLASTIC MATERIAL for Hospital and Health care institute

### FEATURES

- Made out of thermoplastic material
- Special designed to reduce the impact and damage on the wall (following ASTM D-256-90b izod impact strength)
- fungal and bacteria protection as per ASTM G-21 & ASTM G-22
- Chemical and strain resistance as per ASTM D – 543
- Fire resistance as per ASTM D-635-74
- Suitable for almost all type of hospital and healthcare institution
- Available in different ranges of colour to suit the interior of the hospital
- Cost effective and Easy installation

### MATERIALS

- Extruded Thermoplastic Snap on Cover of 2mm,
- Injection moulded Thermoplastic end cap
- Aluminium Extrusion of 2mm thick conforms to 6063 -T5/T6

### WARRANTY

GUARDIO-KANTAFLEX warrants the material to be free of defects for a period of 5years. material must be installed as per approved installation instruction.

GUARDIO-KANTAFLEX shall not be liable for any injury, loss and damage arising out of the use of the product.

INSTALLATION	As per the installation instructions produced by the Manufacturer
PACKING & DELIVERY	Unopened factory packing, deliverable directly to the jobsite
STORAGE	Must be kept inside a closed environment away from direct sunlight and moisture

# KCG 51A

## CORNER GUARD

### SPECIFICATIONS.

1. CONTINUOUS EXTRUDED SNAP ON COVER 1m
2. CONTINUOUS EXTRUDE ALUMINIUM EXTRUSION 1m
3. COVER CAP
4. 6X60 ANCHOR

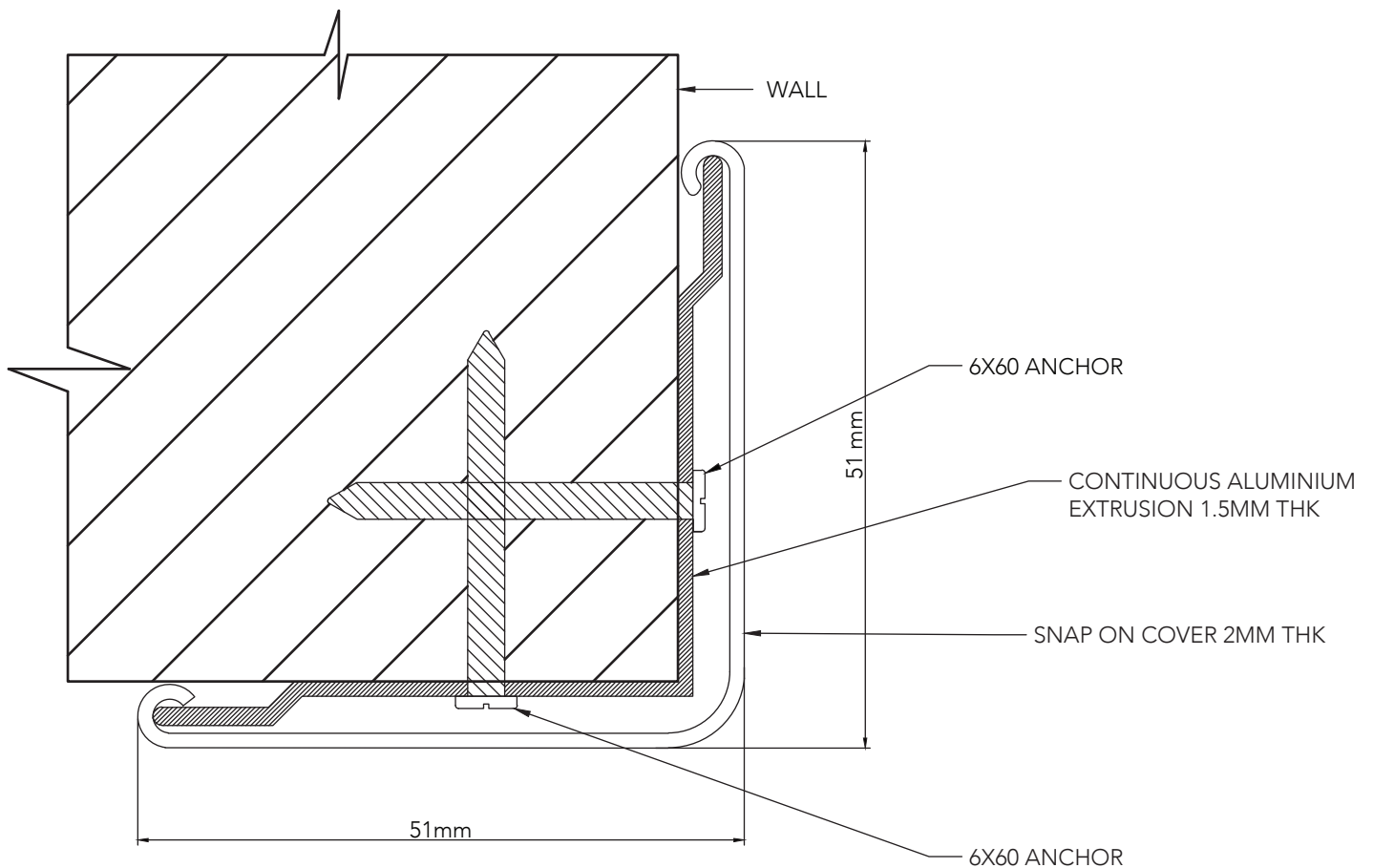

**\*\*NOTE : FOLLOW MANUFACTURER INSTALLATION PROCEDURE  
FOR FURTHER INSTALLATION DETAILS**

### RIGHTS OF DESIGN

The information contained here in is the proprietary property of KANTAFLEX. No portion of it may be reproduced by any means or used in any form except for the purpose for which it was furnished. All rights of the design and invention are hereby reserved.

# KCG 51A

CORNER GUARD

EXPLODED VIEW/  
COMPONENT VIEW



## INSTALLATION INSTRUCTION

COMPONENTS REQUIRED	TOOLS REQUIRED
Aluminium extrusion	Hammer
Snap on cover	Tape measure
Cover cap	Power drill
6x60 sleeve anchor	Drill bits - masonry
	Power mitre saw

### IMPORTANT

Install in accordance with manufacturer's installation procedure. Failure to do so will void the warranty. The information contained herein is the proprietary property of GUARDIO-KANTAFLEX, inc. No portion of it may be reproduced by any means or used in any form except for the purpose for which it was furnished. All rights are hereby reserved.

#### STEP 1 :

Clear measurements of the Walls corner's Height should be taken

#### STEP 2 :

Cut the Aluminium extrusion as per the wall length minusing the length of the cover cap on both the sides  
Drill the holes on the Aluminium extrusion as per the GAD providedby the manufacturer , As sown in Fig.1



**STEP 3 :**

Drill Holes on the wall as per the as per the holes on the Aluminium Extrusion, Keeping it as a Template, As shown in Fig.2

Fig.2



Fig.3



**STEP 4 :**

Install the Aluminium Extrusion to the wall using the 6x60 Anchors provided. As shown in Fig.3

Fig.4



Fig.5



**STEP 5 :**

Cut the Snap on cover as per the extrusion length As shown in Fig. 4 and Install the Snap on Cover to the Aluminium Extrusion installed on the wall As shown in Fig. 5

Fig.6



Fig.7



**STEP 6:**

Install the cover cap to the top and bottom , As shown in Fig. 6 & 7